

Manual Instruction

1. Features

This product adopt world-wide used 2.4GHz frequency, GFSK control method, with the features of low power consumption, long distance transmitting, strong anti-interference and fast communication rate. It can control our 2.4GHz RF smart lights and controllers with color changing, color Temperature adjust, saturation and brightness changing.

2. Product Size

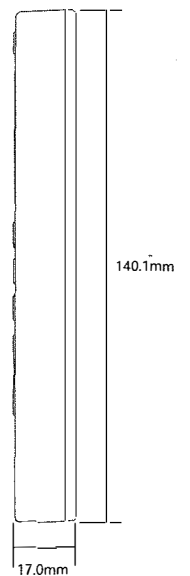
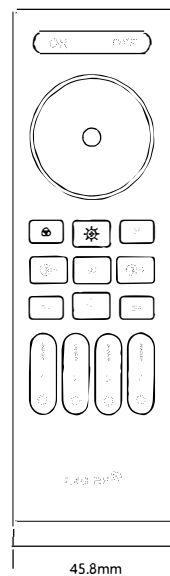

2.4GHz RF 4-Zone Remote Control

Model Number: RC01RF/RC01RFB/RC02RF/RC02RFB/RC03RF/RC03RFB

3. Button Instruction

(1). RC01RF/RC01RFB: 4-Zone Dimming Remote Control

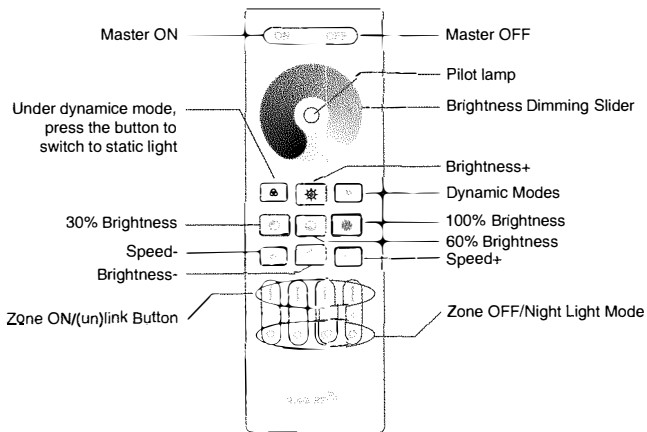

- Press the button to turn ON all linked devices.
- Press the button to turn OFF all linked devices.
- Touch the slider to dim the brightness from 1%-100%.
- Under dynamic mode, press the button to switch to static light.
- Press the button to switch the dynamic modes repeatedly.
- Press the button to dim the brightness up.
- Press the button to dim the brightness down.
- Press the button to get the 30% brightness.
- Press the button to get the 60% brightness.
- Press the button to get the 100% brightness.
- Lower the dynamic mode speed.
- Accelerate the dynamic mode speed.

(2). RC02RF/RC02RFB: 4-Zone DIM&CCT Remote Control

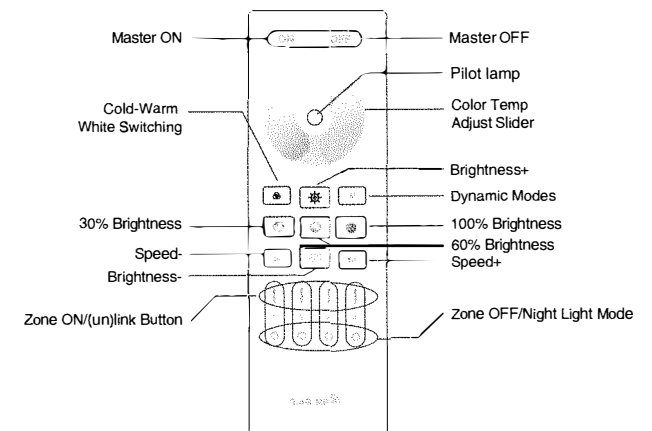

- Press the button to turn ON all linked devices.
- Press the button to turn OFF all linked devices.
- Touch the slider to dim the brightness from 1%-100%.
- Press the button to switch the cool white, nature white and warm white repeatedly.
- Press the button to switch the dynamic modes repeatedly.
- Press the button to dim the brightness up.
- Press the button to dim the brightness down.
- Press the button to get the 30% brightness.
- Press the button to get the 60% brightness.
- Press the button to get the 100% brightness.
- Lower the dynamic mode speed.
- Accelerate the dynamic mode speed.

(3). RC03RF/RC03RFB: 4-Zone RGB&RGBW&RGB CCT Remote Control

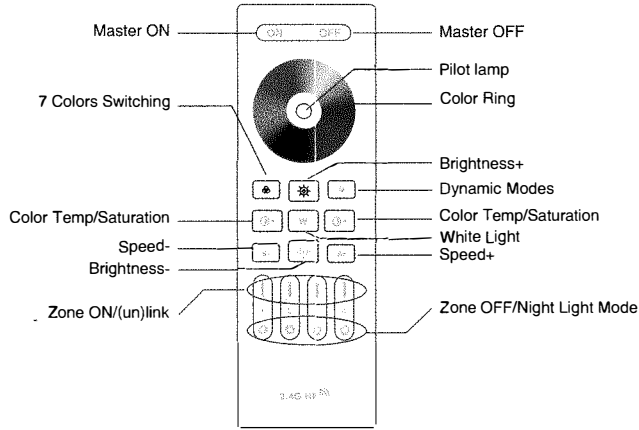

- Press the button to turn ON all linked devices.
- Press the button to turn OFF all linked devices.
- Touch the color ring to change the colors.
- Short press the button to switch the pure colors from orange, yellow, green, cyan, blue, purple and red repeatedly.
Long press the button to switch the pure colors from orange, yellow, green, cyan, blue, purple and red gradually.
- Press the button to get the white light.
- Control RGB CCT LED, Press the W button first and adjust the color Temperature.
Control RGBW LED, it doesn't work on color temperature adjustment.
Control RGB LED, Press the W button first and adjust the color Temperature.
Note: The color temperature value is not very accurate, because it is RGB color mixing to adjust the color temperature.
Light up other colors of light (except for white light), change color saturation
- Press the button to switch the dynamic modes repeatedly.
- Press the button to dim the brightness up.
- Press the button to dim the brightness down.
- Lower the dynamic mode speed.
- Accelerate the dynamic mode speed.

4. Linking and Unlinking Instruction



Remark: The light can be working after linking with the remote.

Linking Instructions

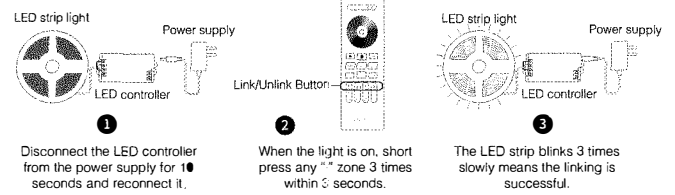

Linking failed if light is not blinking slowly. Please follow above steps again.
(Note: Light that have linked can't link again)

Unlinking Instructions

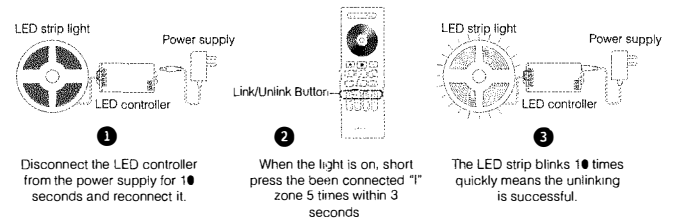

Unlinking failed if light is not blinking quickly. Please follow above steps again.
(Note: Light haven't linked that don't need to unlink)

5. Group Control

You can add an endless numbers of lights to a zone on the 4 channel remote by linking the lights to different zones. This way you are completely flexible in creating different group combinations. Below you can see some grouping examples.

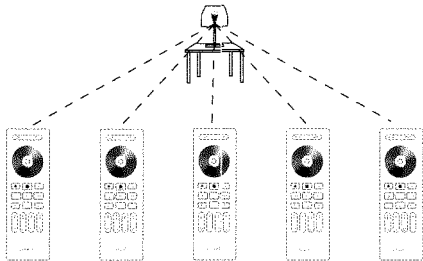
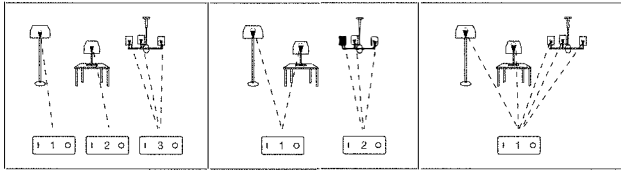

Remark:

- 1. The user can re-programme freely as needed. One remote can control countless lamps or controllers, but one lamp or controller can only be controlled by five remotes (Max)
- 2. Please check the battery installation and controller (totally discharge the power), when you programme after switching off and switching on.

6. Matching Controller

RC01RF/RC01RFB: WB5, LM051, LM052, LM053, C01W, C01RF
RC02RF/RC02RFB: WB5, LM051, LM052, LM053, C02W, C02RF
RC03RF/RC03RFB: WB5, LM051, LM052, LM053, C03W, C04W, C05W, C03RF, C04RF, C05RF

Wi-Fi Controller Alexa,Google Home:	WB5, C01W, C02W, C03W, C04W, C05W
Bluetooth Mesh Controller:	LM053
Zigbee3.0 Controller:	LM052
2.4GHz RF Controller:	LM051, C01RF, C02RF, C03RF, C04RF, C05RF

LM052,LM053,WB5,C01W,C02W,C03W,C04W,C05W all of them can work with RF Remote and Tuya Smart ,SmartLife APP

7. Attention

- 1. This remote only control our 2.4GHz RF products; cannot control other products not made by us.
- 2. In the using of the remote, if the indicated amp blinking quickly, Please change the battery in time. Please don't use poor quality battery to avoid the leaking of battery liquid to damage the remote.
- 3. This 2.4GHz remote is precise electronic product; don't use it in humid, high temperature, dust and high voltage environment; Saving it at indoor, dry and no static electricity environment.
- 4. Please don't use the remote on the wide-range metal or strong electromagnetic wave area, otherwise, it will badly affect the controlling distance.
- 5. Non-professional user cannot dismantle the controller directly, otherwise, it may cause fire and electric shock.
- 6. The working temperature is 20~45°C; Do not use the device to direct sunlight moist and other high temperature area.
- 7. Please do not use controller around the mental area and high magnetic field, otherwise it will badly affect the control distance.
- 8. contact@btf-lighting.com Welcome to consult
- 9. www.btf-lighting.com

Made in China

