

LED WALL PACK LIGHT - WPD SERIES

Introduction

- ◆ The WPD series is available in lumen packages from 4,650 to 19,375 lumens with a wide and even distribution. Since WPD occupies the same area as a typical metal halide glass wall pack, it can completely cover unsightly stains.
- ◆ A high-quality polycarbonate lens, which works with a high-efficiency driver to provide superior illumination.
- ◆ Available with Emergency battery backup, and Photocell.

Features

Construction:

- ◆ Rugged die-casting aluminum housing with bronze powder coating for durability. Castings are sealed with integral gaskets to prevent the ingress of external contaminants. It has 4-6KV surge protection. Consult factory for Photocell surge ratings.

Optics:

- ◆ These wall packs feature high-efficiency LEDs. Color temperature (CCT) options are 4000K, 5000K single color and 3000K/4000K/5000K selectable, with a minimum CRI of 70

Electrical:

- ◆ The Input voltage is AC120-277V (50/60Hz). Electronic drivers ensure system power factor >90%. 0-10V dimming driver is standard.

Finish:

- ◆ Standard color is dark bronze



Warranty:

- ◆ Standard 5 years warranty

Product Selectable:



▲ ▲
WATTAGE SELECTABLE

WATTAGE SELECTABLE



WATTAGE SELECTABLE



CCT SELECTABLE

Compliances:

- ◆ cULus listed for wet locations, max ambient temperature rating 45°C
- ◆ DLC® (DesignLights Consortium) Qualified.

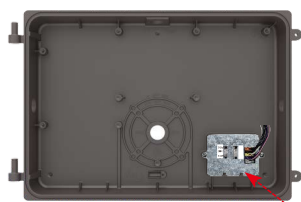

Wattage & CCT Selectable - Dial in the desired lumens and CCT via the dial located in the fixture.



The geometry covers the footprint of a typical HID wall pack, covering any unsightly stains.



Emergency test button and indicator.



Parameters

Model	Wattage	Lumen@5000K 150LM/W	CCT	Lens	Input Voltage
FWPX30VW-VK	(30/45/63)W Selectable	Max 9,976LM	3000/4000/5000K Tunable	PC	AC120-277V 50/60Hz
FWPX45VW-VK	(45/63/90)W Selectable	Max 13,950LM	3000/4000/5000K Tunable	PC	AC120-277V 50/60Hz
FWPX76VW-VK	(76/105/125)W Selectable	Max 19,375LM	3000/4000/5000K Tunable	PC	AC120-277V 50/60Hz

Dimension

Unit:Inch/mm

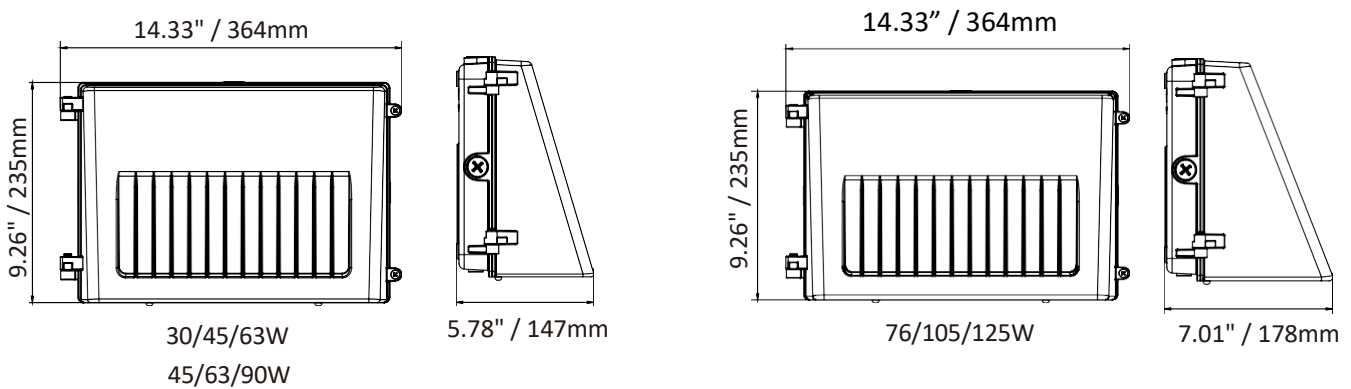

Photometrics

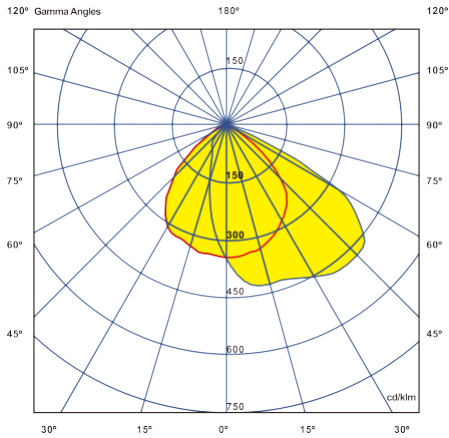

Accessories



Photocell



8W Emergency battery backup
(apply to 30W-125W WPD)

Electrical data

Voltage (V)	WPD(30/45/63)W Max Current (A)	WPD(45/63/90)W Max Current (A)	WPD(76/105/125)W Max Current (A)
120V	0.53	0.75	1.04
208V	0.30	0.43	0.60
240V	0.26	0.38	0.52
277V	0.23	0.32	0.45
347V	0.18	0.26	0.36