



DISCLAIMER: These instructions are suggested installation procedures only. Brilliant Brand Lighting assumes no liability for problems, damages, injuries, or expenses that may occur from improper installation or product failure. These instructions do not constitute professional installation and may not necessarily meet all electrical requirements in your state. If you are uncomfortable with any of these procedures please contact a licensed electrical contractor.

RGB LED ROPE LIGHT INSTRUCTIONS

CUTTING INTERVALS:

The length of your LED rope light is customizable and may be cut to size in specific intervals only. Can't find the mark? For more info on cutting intervals please contact your supplier.

 Never attempt to cut or install other accessories while RGB LED rope lights are plugged in to a power source.

1 If you follow the rope light approximately 39" from the end, you will find a scissor icon that indicates where to make your cut.

2 Use Brilliant Brand rope light cutters or other heavy duty shears to make a perpendicular cut between bulbs where the cut mark is located.

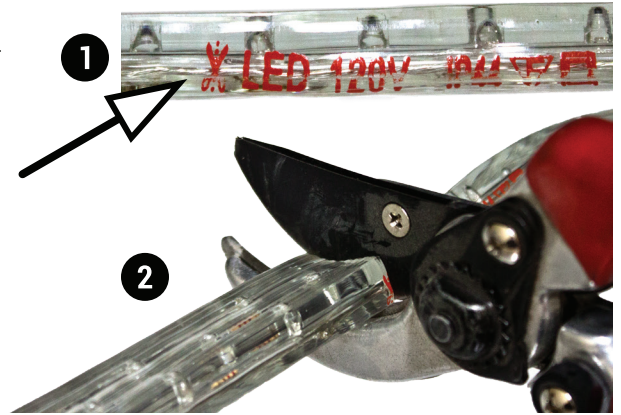

CONNECTING TO AN ACCESSORY FEMALE END:

- 1** Attach power connector to one end of the RGB rope light using "Installing the RGB power connector" instructions (pg 2).
- 2** Gently insert power connector into rope light.
- 3** Optional: Use PVC or silicone sealant to secure and/or waterproof all connections.
- 4** Insert rounded prongs of power connector into the accessory.
- 5** Attach an end cap to end of the rope light run. (If not previously installed)

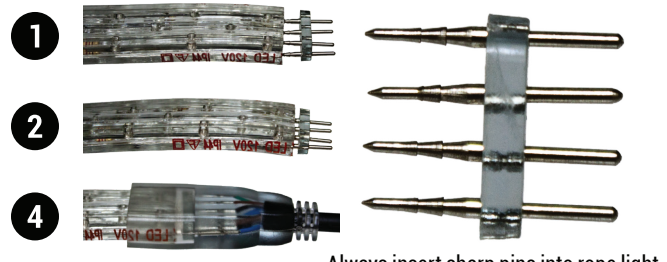

Always insert sharp pins into rope light and rounded pins into accessories.

USING AN RGB SPLICE

- 1** Attach power connector to one end of the RGB rope light using "Installing the RGB power connector" instructions (pg 2).
- 2** Gently insert power connector into the end of the second section of RGB rope light.
- 3** Optional: Use PVC or silicone sealant to secure and/or waterproof all connections.
- 4** Align power connector with the center groove of one half of the splice clam shell.
- 5** Align second half of the splice clam shell and tighten screws to complete installation.
- 6** Attach an end cap to end of the rope light run. (If not previously installed)

 **WARNING:** When using rope lighting outdoors, waterproof PVC or silicone is required to seal all connections, power cords, and end caps. NOTE the use of any non-recommended sealant e.g. electrical tape, may result in a rope light or rope light accessory failure and will void the warranty.

 **WARNING:** LED Rope lights produce excessive heat operating while spooled. Fully unspool all LED lights before operation. Failure to do so may result in damage to the lighting and or property.

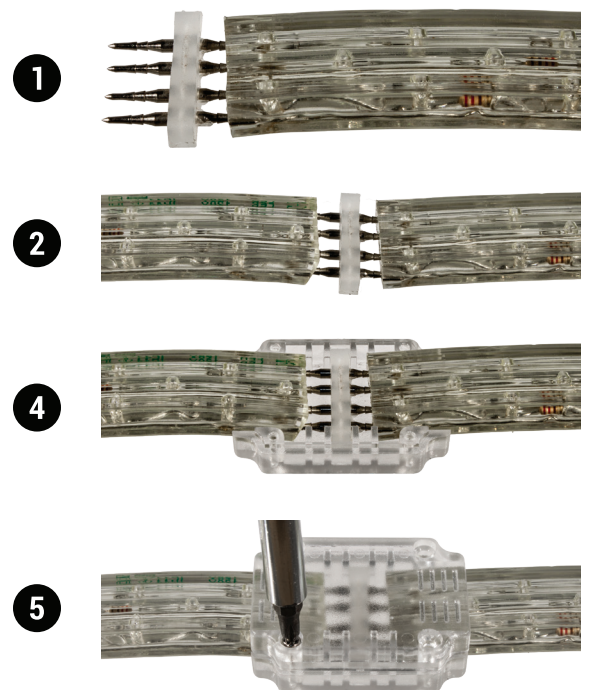



NOTE: LED rope lights are polarized. If they do not light up when you first plug them in, simply unplug the power cord and reinstall connection 180° from the original configuration, or insert the power connector in the opposite end of the rope light.

INSTALLING RGB POWER CONNECTOR:

All 4 pins must be inserted correctly for safe and correct operation of the rope light.

 Never attempt to cut or install other accessories while RGB LED rope lights are plugged in to a power source.

1 Locate and identify each of the 4 wires in the RGB LED rope light. Note the 3 large air holes are not connection points.



2 Align the pin on one of the sides of the connector with corresponding wire on the RGB LED rope light. Note the pins and holes are offset and must be aligned before they are inserted.

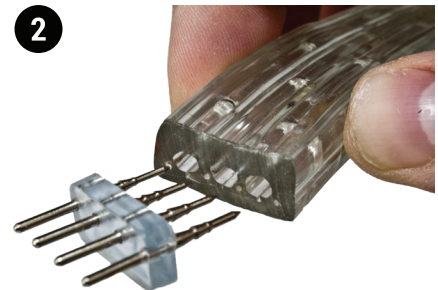

3 Gently insert the first pin partially into the RGB LED rope light making sure to make a solid connection with the internal wire.

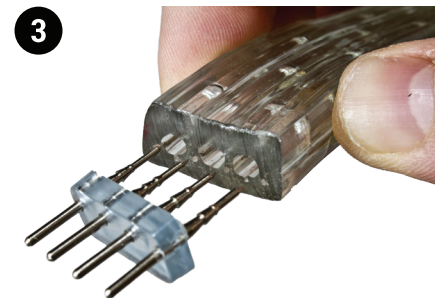

4 Repeat step 3 with the remaining pins starting with the next adjacent pin to the one previously inserted. Note if the pins do not make a solid connection with the internal wire the RGB LED rope light will not function properly.

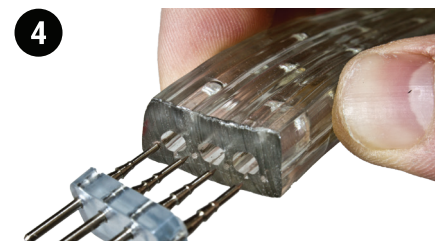

5 After all pins have been inserted and have made a solid connection continue to gently insert the pins into the RGB LED rope light until it becomes difficult to do so, making sure that all pins are inserted evenly. Note the pin does not need to be fully inserted so that the plastic on the pin makes contact with the rope light.

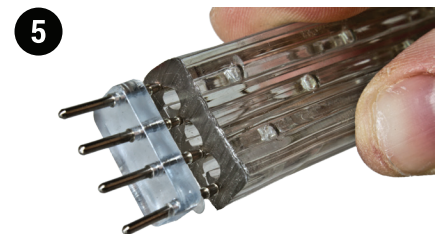

 **WARNING:** When using rope lighting outdoors, waterproof PVC or silicone is required to seal all connections, power cords, and end caps. NOTE the use of any non-recommended sealant e.g. electrical tape, may result in a rope light or rope light accessory failure and will void the warranty.